

What's NEW in VERICUT Composites Simulation 9.0.1

IMPORTANT! - Licensing is NOT included with software shipments. See "To Get a License" below for details.

February 28, 2019

Dear VERICUT® User:

Thank you for your continued investment in VERICUT, an important part of your NC programming and machining process!

VCS 9.0.1 features a new graphics engine which provides sharper, clearer and more realistic views of machines and the machining process. These changes and more will be described in the following pages. Please take a moment to review what's new and improved in this release.

Maintenance and Licensing Information

NOTE: This software requires VERICUT 9.0 licensing.

To Get a License – use the link below to submit a License Request:

http://www.cgtech.com/vericut_support/request-license/.

Licensing is sent via Email only.

VCS 9.0.1 runs on 64 bit Windows, and is supported on Windows 7 and Windows 10 computers. It is not available for 32 bit Windows computers.

VERICUT's license server will continue to run and be supported on 32 bit or 64 bit computers.

Software maintenance keeps you on the cutting edge - CGTech provides update software to customers with current software maintenance. Your continued maintenance ensures that you have the most advanced verification technology available. If your maintenance has expired, please contact your CGTech representative (<http://www.cgtech.com/about/contact-us/>).

Sincerely,

Andre Colvin

CGTech VERICUT Composites Product Manager

VERICUT 9.0 Release Highlights

Enhanced graphics display

V9.0's greatly enhanced image quality provides sharper, clearer views that make it easier to spot problems and imperfections in machined parts.

Get optimal performance running simulations in a single view. Switch seamlessly between Workpiece, Machine, or Profile views, or view layouts for optimal viewing.

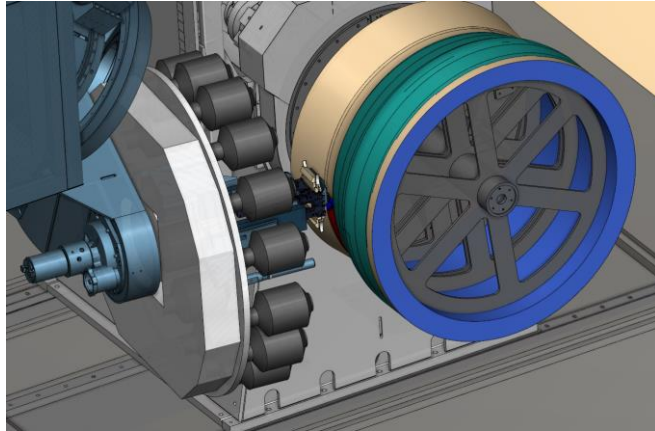

Streamlined verification

Any of VERICUT's major functions, such as Section and X-Caliper, can be used in any view which streamlines the verification effort and increases productivity.

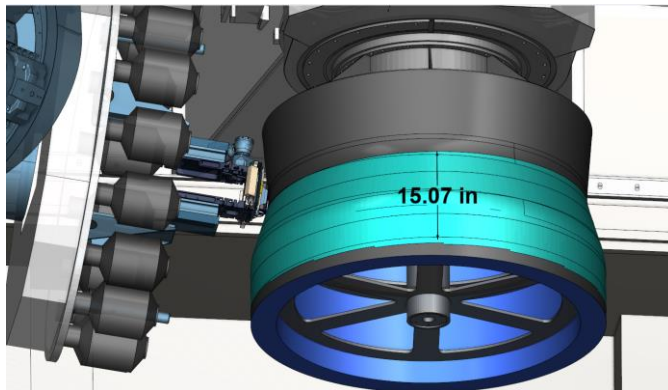

Appearance Settings

Appearance settings accompany the "Color" option for components and models, and can be used to add realism to objects in VERICUT simulations. A list of common materials is provided and can be used to make NC machines, cutting tools, fixtures, and machined parts look more lifelike, as well as easier to identify errors or incorrect cuts.

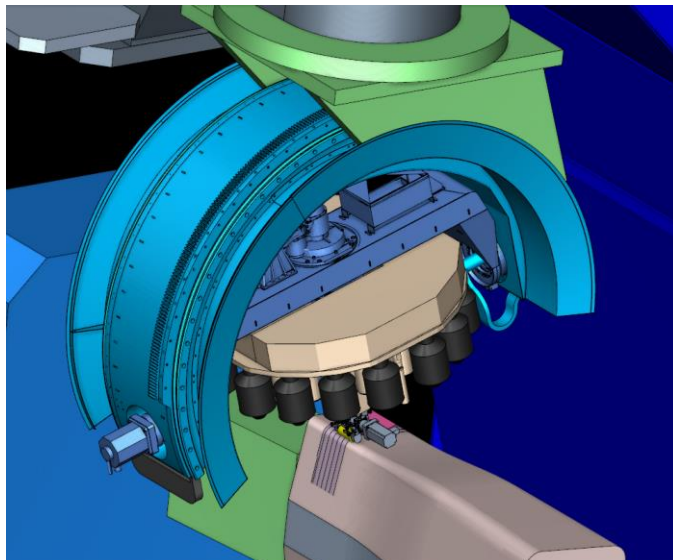

Enhanced Translucency and New Stock/Design View

Translucency can be applied to machine components or the form model, then adjusted by the Translucency slider on the View tab. Translucency can also be set individually via the aforementioned Appearance Settings.

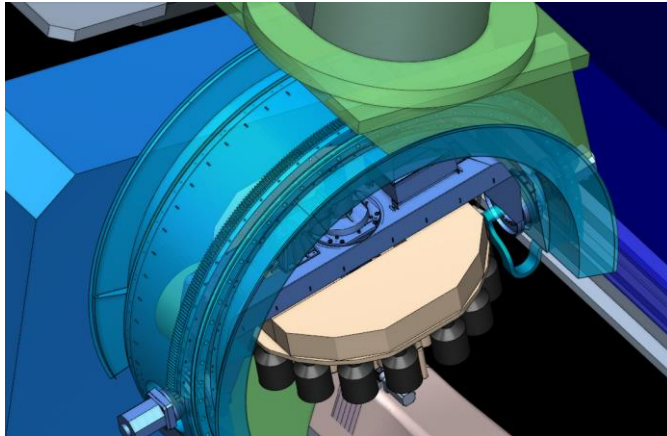

New Section Window

The new Section window is easier to use with dynamic section plane locations and angle adjustments. More options are available for how section planes are defined, including easy $\frac{3}{4}$ "wedge" section views, control over which object(s) are sectioned, and which view show sectioned objects.

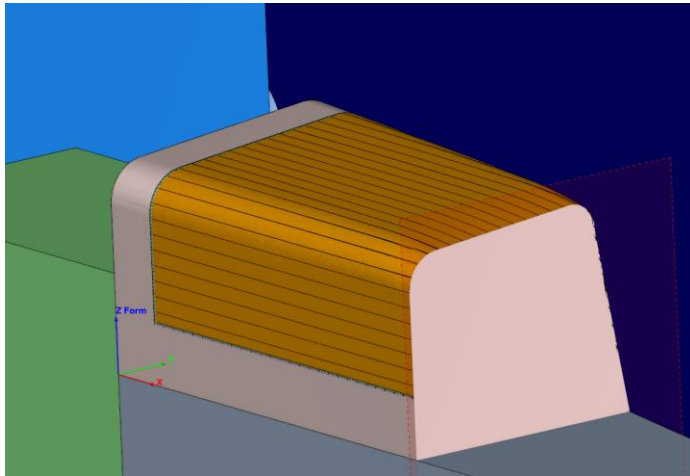

Enhanced Reviewer App

The Reviewer application is powered by the same enhanced graphics engine yet featured and users will also immediately notice the dramatic boost in performance!

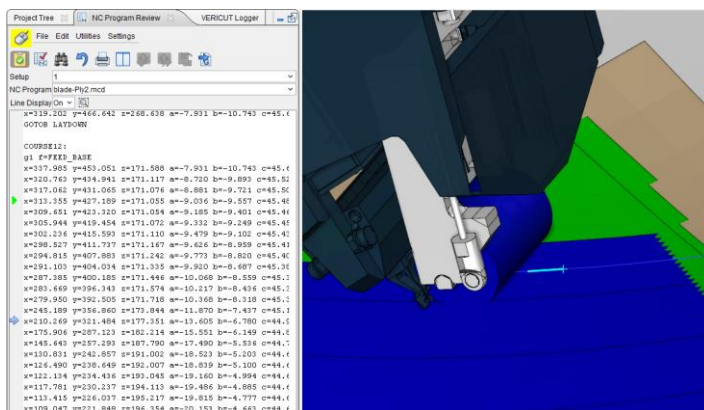

Enhancements and Changes in V9.0

Verification

Greater flexibility with views: ability to use “Picture in Picture” (small view in a large view) view layouts, multiple large views, etc.

Fit function is replaced with “Fit Selected” and will fit selected components or models, or fit all when nothing is selected.

Right-mouse menu option added to switch contents between two views.

HUD (Head Up Display) enable/disable option added in right-mouse menu.

Section: ability to section through machine components.

Section: ability to define view-specific section.

Section: dynamic sectioning that follows the Tool.

X-Caliper: “Stock/Design Distance” automatically make Design component visible when needed for measurements.

X-Caliper: ability added to measure and display dimensions in sectioned views.

NC Program branch of Project Tree can be double clicked or right-clicked to load files.

Change List panel: support added for specifying “Flash” tool (multi-function tooling) orientation values.

VCS now supports native Windows File Selection and browsing capabilities.

Machine Simulation

Refine Display now also works in Machine views to provide clearer views of the cut part.

Auto Refine Machine Animation performance and behavior have been greatly improved.

Improvements for robot machine building, and simulation.

And many more!